

THE BENJAMIN



Exterior A

2,371 - 2,390 sq. ft.

4 Bedrooms

3 Full Baths

2 Car Garage



Exterior B

Shane



We're living our fairytale thanks to David Weekley

We can't say enough about the level of quality and care we received while building our home. Our builder was with us every step of the way to make sure our every need and desire was being met! The team truly went above and beyond at every turn to give us the home of our dreams! We will definitely recommend David Weekley to anyone looking to build a new home!

**David Weekley
Homes**

THE BENJAMIN

2,371 - 2,390 sq. ft. • 4 Bedrooms • 3 Full Baths • 2 Car Garage

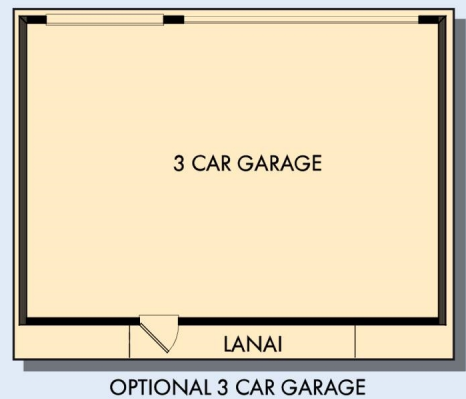
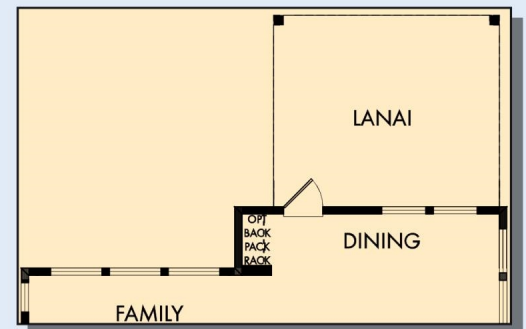
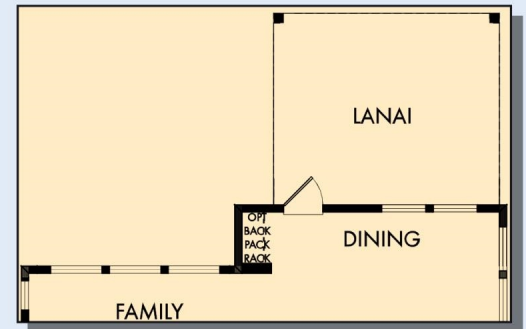
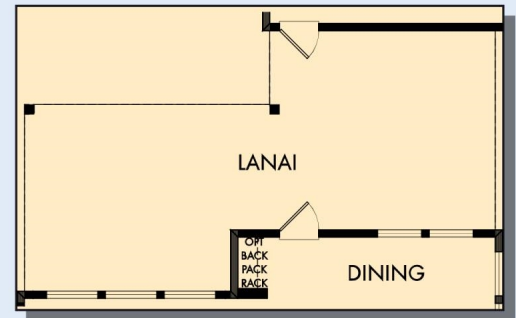

B383 in 4495 JAC

For additional options, please visit DavidWeekleyHomes.com

4/7/2022

DavidWeekleyHomes.com

THE BENJAMIN



OPTIONAL DROP-IN TUB
WITH SEPARATE SHOWER
AT OWNER'S BATH



OPTIONAL SLIDE-IN TUB
WITH SEPARATE SHOWER
AT OWNER'S BATH



For additional options, please visit DavidWeekleyHomes.com



See a David Weekley Homes Sales Consultant for details.
Prices, plans, dimensions, features, specifications, materials,
and availability of homes or communities are subject to
change without notice or obligation. Illustrations are artist's
depictions only and may differ from completed improvements.
Copyright © 2022 David Weekley Homes - All Rights Reserved.
Jacksonville, FL

DavidWeekleyHomes.com