

# THE LOVENIA



Exterior A

1,857 sq. ft.

3 Bedrooms

2 Full Baths

1 Half Bath

2 Car Garage



Exterior B



Exterior D

David Weekley  
Homes

# THE LOVENIA

1,857 sq. ft. • 3 Bedrooms • 2 Full Baths • 1 Half Bath • 2 Car Garage



B344 in 5330 SLC

For additional options, please visit [DavidWeekleyHomes.com](http://DavidWeekleyHomes.com)

6/22/2021

**DavidWeekleyHomes.com**



# THE LOVENIA



SECOND FLOOR

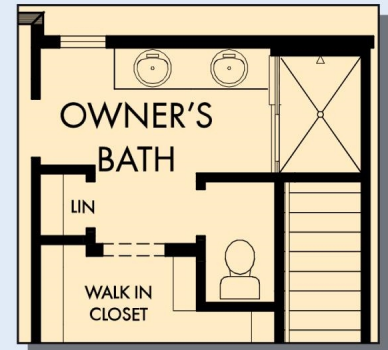

OPTIONAL EXTENDED  
SHOWER AT  
OWNER'S BATH

For additional options, please visit [DavidWeekleyHomes.com](http://DavidWeekleyHomes.com)



See a David Weekley Homes Sales Consultant for details. Prices, plans, dimensions, features, specifications, materials, and availability of homes or communities are subject to change without notice or obligation. Illustrations are artist's depictions only and may differ from completed improvements. Copyright © 2021 David Weekley Homes - All Rights Reserved. Salt Lake City, UT

**DavidWeekleyHomes.com**