

# THE BROMLEY



Exterior B

2,301 - 4,602 sq. ft.

3 - 5 Bedrooms

2 - 3 Full Baths

0 - 1 Half Baths

3 - 4 Car Garage

## Jordan



### Greatly exceeded every expectation! A+++!

The entire experience was excellent from the first day I showed up to look at houses. The whole team came together to provide a truly quality house that I will be living in for years to come. Kajal helped me purchase the house and coordinated all meetings. She was very cheerful and professional at all times and I could tell that she cared about her clients and my family. Jeff and Robbie were builders that always went the extra mile to ensure total customer satisfaction. Jeff was very helpful and I am grateful to his management and know that I will be moving in to a house that is built right with a great attention to detail... Ashley also provided Kajal with assistance whenever Kajal was not available. I could not be happier with everyone involved in building this house. David Weekley is a great company and I would enthusiastically recommend them to others needing a quality house built in the future. Thank you for such a great experience and I hope that this company continues to grow.

## Shane



### We're living our fairytale thanks to David Weekley

We can't say enough about the level of quality and care we received while building our home. Our builder was with us every step of the way to make sure our every need and desire was being met! The team truly went above and beyond at every turn to give us the home of our dreams! We will definitely recommend David Weekley to anyone looking to build a new home!

**David Weekley  
Homes**

# THE BROMLEY

2,301 - 4,602 sq. ft. • 3 - 5 Bedrooms • 2 - 3 Full Baths • 0 - 1 Half Baths • 3 - 4 Car Garage



OPTIONAL DECK AT DINING



OPTIONAL COVERED DECK AT DINING

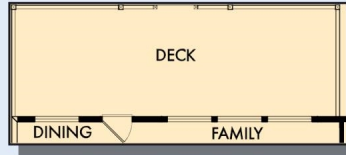

OPTIONAL EXTENDED DECK AT DINING AND FAMILY

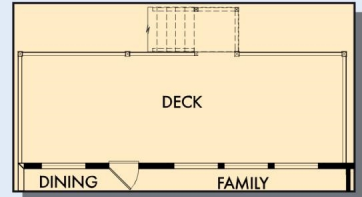

OPTIONAL EXTENDED DECK WITH DAYLIGHT/WALKOUT BASEMENT

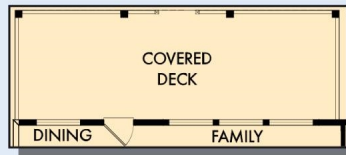

OPTIONAL EXTENDED COVERED DECK AT DINING AND FAMILY

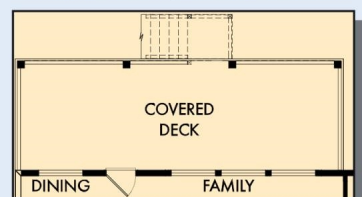

OPTIONAL EXTENDED COVERED DECK WITH DAYLIGHT/WALKOUT BASEMENT

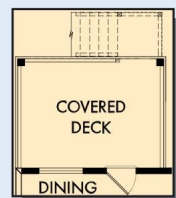

OPTIONAL COVERED DECK WITH DAYLIGHT/WALKOUT BASEMENT

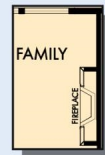

OPTIONAL WALL FIREPLACE AT FAMILY



OPTIONAL GUEST SUITE WITH GUEST BATH AT BEDROOM 2 AND 3



OPTIONAL POWDER BATH AT HALL WAY



OPTIONAL DROP-IN TUB WITH SEPARATE SHOWER AT OWNER'S BATH



OPTIONAL FREE STANDING TUB WITH SEPARATE SHOWER AT OWNER'S BATH



OPTIONAL SUPER SHOWER AT OWNER'S BATH

# THE BROMLEY

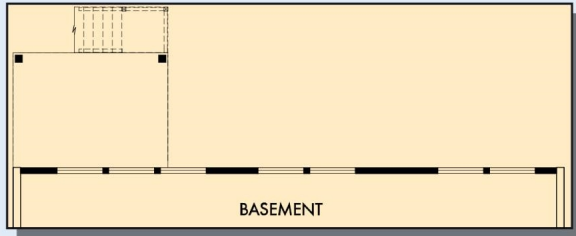

OPTIONAL DAYLIGHT BASEMENT

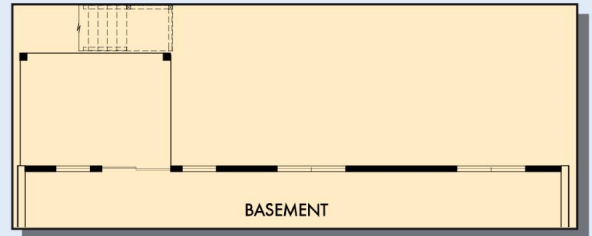

OPTIONAL WALKOUT BASEMENT

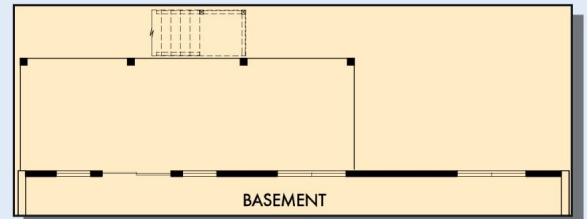

OPTIONAL EXTENDED COVERED DECK WITH DAYLIGHT/WALKOUT BASEMENT

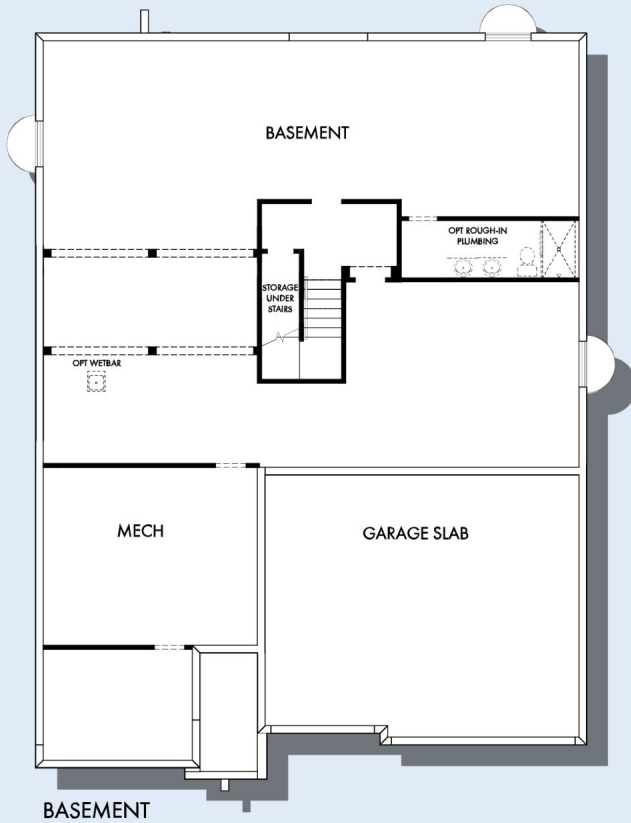

BASEMENT

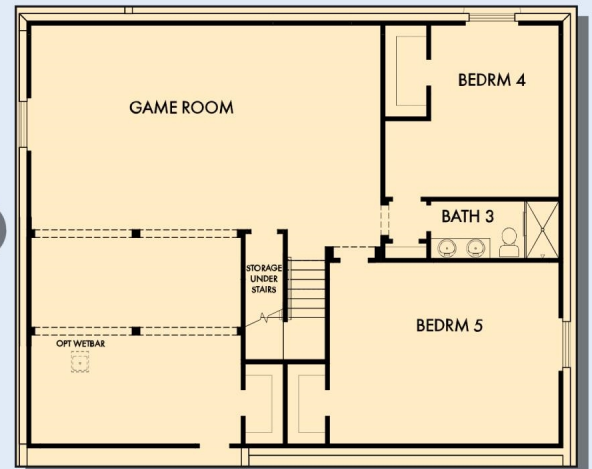

OPTIONAL GAME ROOM WITH BEDROOM 4, 5 AND BATH 3 AT BASEMENT

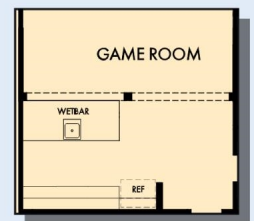

OPTIONAL WETBAR AT GAME ROOM

For additional options, please visit [DavidWeekleyHomes.com](http://DavidWeekleyHomes.com)

See a David Weekley Homes Sales Consultant for details. Prices, plans, dimensions, features, specifications, materials, and availability of homes or communities are subject to change without notice or obligation. Illustrations are artist's depictions only and may differ from completed improvements. Copyright © 2024 David Weekley Homes - All Rights Reserved. Salt Lake City, UT

**DavidWeekleyHomes.com**

