

# THE DARLTON



7814 MIN - A

Exterior A

2,034 - 2,043 sq. ft.

2 - 5 Bedrooms

2 - 3 Full Baths

1 Half Bath

3 Car Garage



7814 MIN - B

Exterior B

**Rich C.**



### **Wonderful Experience!**

If there is anything that sets David Weekley apart from other builders it is their customer service. I felt like a member of the family from the first time I walked into the model, to when I received my keys and saw the wonderful housewarming presents that were left for me, up to the present when I see my salesman in the neighborhood. I felt like they really took the time to understand what I was looking for and then came through with my dream home. I would highly recommend David Weekley to anyone looking to buy and/or build a home.

**David Weekley  
Homes**

# THE DARLTON

2,034 - 2,043 sq. ft. • 2 - 5 Bedrooms • 2 - 3 Full Baths • 1 Half Bath • 3 Car Garage



OPTIONAL  
TUB ADN SHOWER  
AT OWNER'S BATH



OPTIONAL  
SUPER SHOWER  
AT OWNER'S BATH

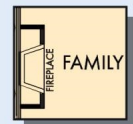

OPTIONAL  
FIREPLACE  
AT FAMILY



# THE DARLTON



OPTIONAL BEDROOM 4  
AT GAMEROOM

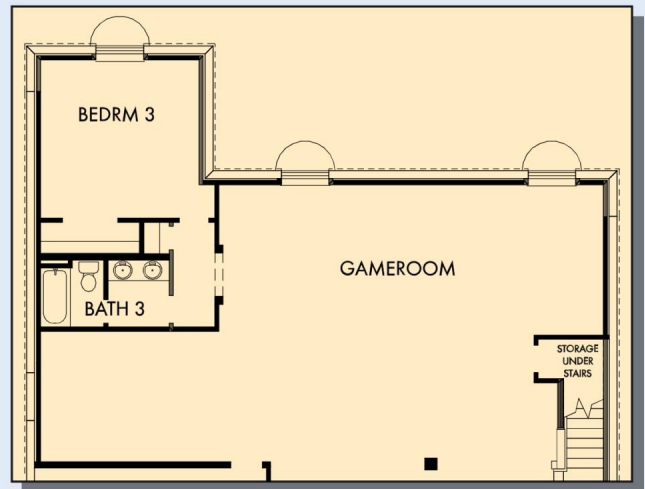

OPTIONAL GAMEROOM WITH BEDROOM 3 AND BATH 3  
AT BASEMENT

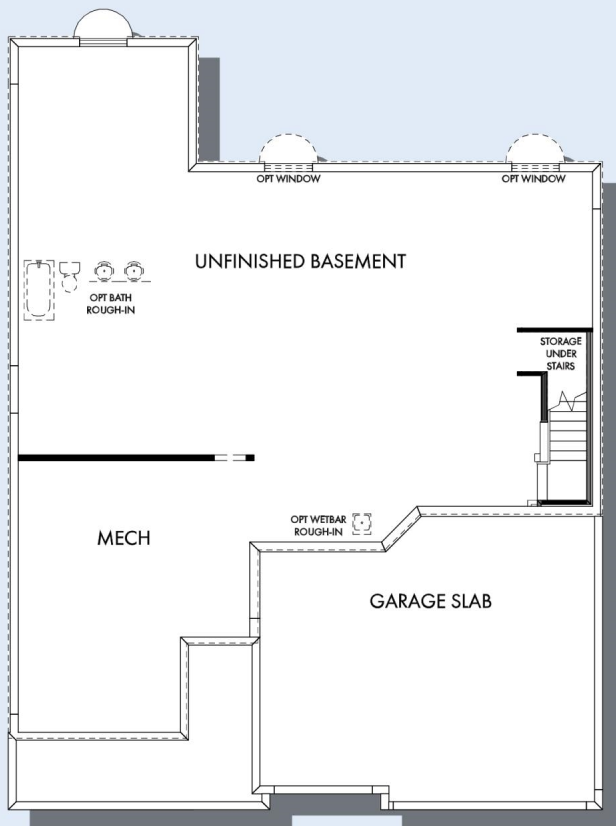

BASEMENT

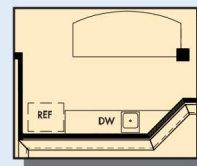

OPTIONAL WET BAR  
AT GAMEROOM

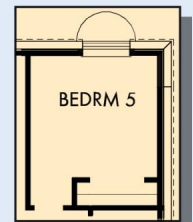

OPTIONAL BEDROOM 5  
AT BASEMENT

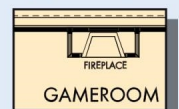

OPTIONAL FIREPLACE  
AT GAMEROOM

For additional options, please visit [DavidWeekleyHomes.com](http://DavidWeekleyHomes.com)

**DavidWeekleyHomes.com**

See a David Weekley Homes Sales Consultant for details. Prices, plans, dimensions, features, specifications, materials, and availability of homes or communities are subject to change without notice or obligation. Illustrations are artist's depictions only and may differ from completed improvements. Copyright © 2019 David Weekley Homes - All Rights Reserved. Minneapolis/St. Paul, MN

