

THE COLTMAN



6260 SAN - C

Exterior C

3,295 - 3,344 sq. ft.

4 - 5 Bedrooms

3 - 4 Full Baths

1 Half Bath

3 Car Garage



6260 SAN - D

Exterior D

Rich C.



Wonderful Experience!

If there is anything that sets David Weekley apart from other builders it is their customer service. I felt like a member of the family from the first time I walked into the model, to when I received my keys and saw the wonderful housewarming presents that were left for me, up to the present when I see my salesman in the neighborhood. I felt like they really took the time to understand what I was looking for and then came through with my dream home. I would highly recommend David Weekley to anyone looking to buy and/or build a home.

**David Weekley
Homes**

THE COLTMAN

3,295 - 3,344 sq. ft. • 4 - 5 Bedrooms • 3 - 4 Full Baths • 1 Half Bath • 3 Car Garage

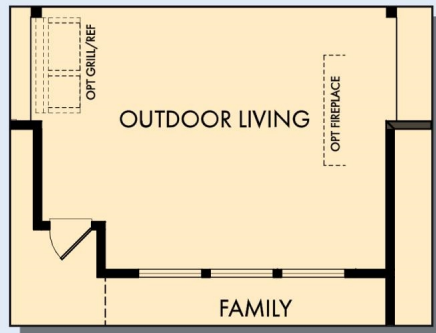

OPTIONAL OUTDOOR LIVING
AT FAMILY



FIRST FLOOR

6260 in 2373 SAN

For additional options, please visit DavidWeekleyHomes.com

11/19/2019

DavidWeekleyHomes.com

THE COLTMAN



OPTIONAL BEDROOM 5 AND BATH 4
AT MEDIA

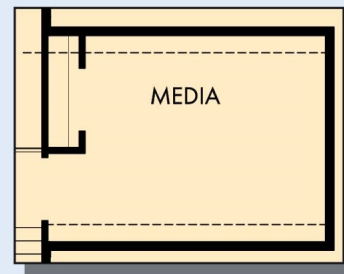

OPTIONAL MEDIA



SECOND FLOOR

For additional options, please visit DavidWeekleyHomes.com



See a David Weekley Homes Sales Consultant for details.
Prices, plans, dimensions, features, specifications, materials,
and availability of homes or communities are subject to
change without notice or obligation. Illustrations are artist's
depictions only and may differ from completed improvements.
Copyright © 2019 David Weekley Homes - All Rights Reserved.
San Antonio, TX

DavidWeekleyHomes.com