

THE VERMILION



Exterior A

2,290 - 3,002 sq. ft.

3 - 5 Bedrooms

2 - 3 Full Baths

1 Half Bath

2 - 3 Car Garage



Exterior B



Exterior C

David Weekley
Homes

THE VERMILION

2,290 - 3,002 sq. ft. • 3 - 5 Bedrooms • 2 - 3 Full Baths • 1 Half Bath • 2 - 3 Car Garage

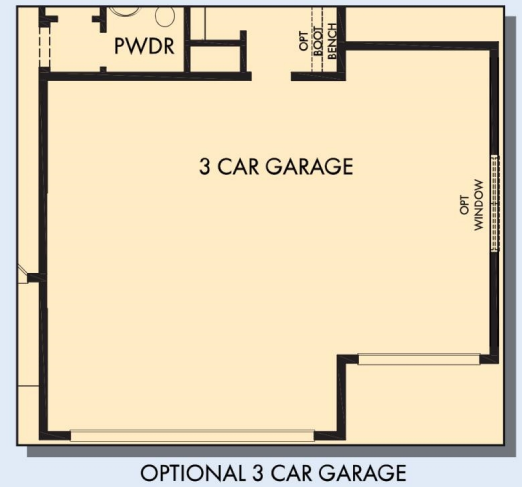
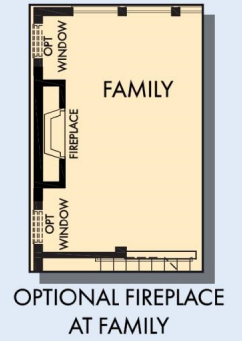

THE VERMILION



OPTIONAL SLIDE-IN TUB WITH SEPARATE SHOWER AT OWNER'S BATH



OPTIONAL SUPER SHOWER AT OWNER'S BATH

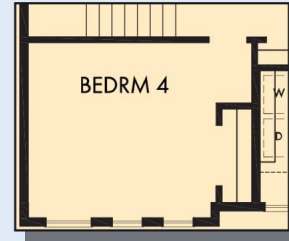

OPTIONAL BEDROOM 4 AT RETREAT



SECOND FLOOR

For additional options, please visit DavidWeekleyHomes.com

DavidWeekleyHomes.com

THE VERMILION

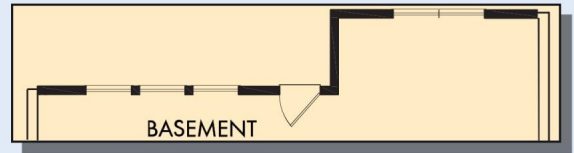

OPTIONAL WALK-OUT AT BASEMENT

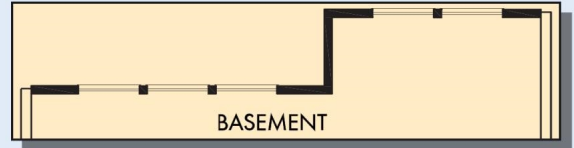

OPTIONAL DAY LIGHT AT BASEMENT

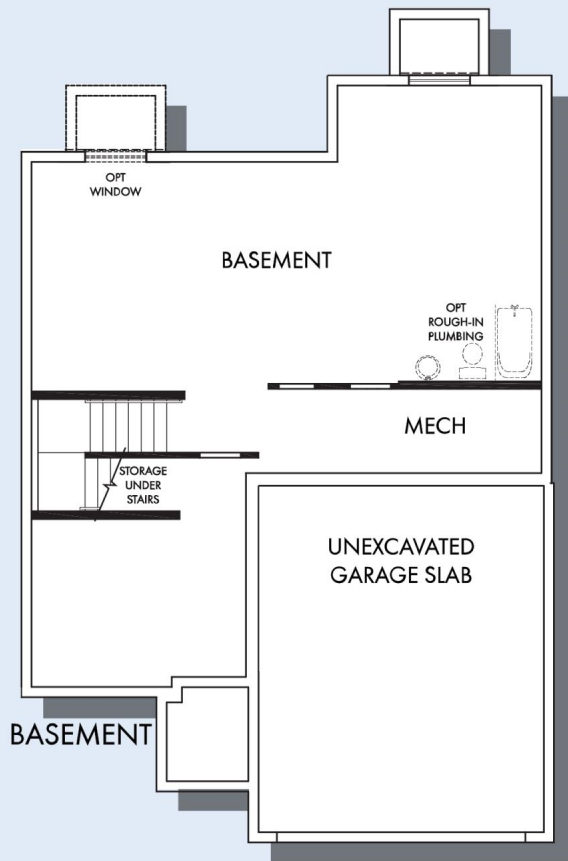

For additional options, please visit DavidWeekleyHomes.com

See a David Weekley Homes Sales Consultant for details. Prices, plans, dimensions, features, specifications, materials, and availability of homes or communities are subject to change without notice or obligation. Illustrations are artist's depictions only and may differ from completed improvements. Copyright © 2024 David Weekley Homes - All Rights Reserved. Minneapolis/St. Paul, MN

DavidWeekleyHomes.com



EQUAL HOUSING OPPORTUNITY