

# THE BEVINGTON



Exterior A

2,191 - 2,247 sq. ft.

2 - 3 Bedrooms

2 - 4 Full Baths

0 - 2 Half Baths

2 - 3 Car Garage



Exterior B

**Crystal W.**  
Atlanta, GA



## Welcome Home

My DWHomes experience has been truly 5-stars! From a floorplan concept, reserving a lot filled with dirt, the homebuilding project, to "Welcome Home", the entire process has been amazing. The team provided regular feedback and were always available to address questions and concerns. I was sold on the quality features. The entire team's availability and service has been exceptional before and after closing. Looking forward to enjoying our new home and neighbors for many years to come!

**Encore**  
by David Weekley Homes

# THE BEVINGTON



5584 in 4670 ATL

For additional options, please visit [DavidWeekleyHomes.com](http://DavidWeekleyHomes.com)

9/13/2019

**Encore**  
by David Weekley Homes

# THE BEVINGTON

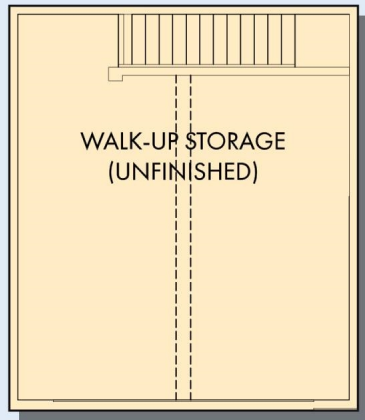

OPTIONAL WALK-UP STORAGE

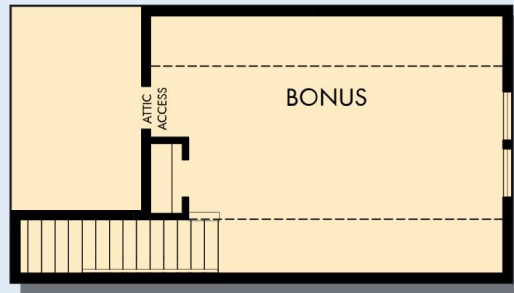

OPTIONAL SECOND FLOOR BONUS

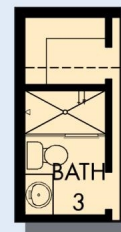

OPTIONAL  
BATH 3 AT  
BONUS

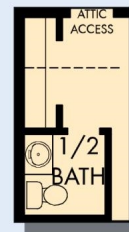

OPTIONAL  
HALF BATH AT  
BONUS

For additional options, please visit [DavidWeekleyHomes.com](http://DavidWeekleyHomes.com)



See a David Weekley Homes Sales Consultant for details. Prices, plans, dimensions, features, specifications, materials, and availability of homes or communities are subject to change without notice or obligation. Illustrations are artist's depictions only and may differ from completed improvements. Copyright © 2019 David Weekley Homes - All Rights Reserved. Atlanta, GA

**Encore**  
by David Weekley Homes